

RECEIVED

NOV - 9 2020



City of Brisbane
Community Development Dept.
50 Park Place
Brisbane, CA 94005
(415) 508-2120

Comm. Dev. Dept. Brisbane

7-Day Notice from Owner to City:
For Severe Tree Trimming or
Removal of Non-protected Mature Tree

City Hall Hours: M-T-Th 8-5, W 8-8, F 8-1

Applicability: Brisbane Municipal Code Section 12.12.050.A allows that following submittal of a 7 calendar day notice to the Community Development Department (CDD), any species of tree may be severely trimmed (as long as the trimming would not result in the death of the tree) and certain tree species may be removed. This form serves as that required notice. A date stamp from the CDD on this form is required for the notice to be considered effective. Approval will be implicit after 7 days, unless the City contacts the owner or owner's agent listed on this form within the 7 day time period to indicate that the severe trimming or removal may not proceed. For information on trees subject to noticing only and standard conditions, please see pages 3 and 4 of this handout. Note that the CDD will require access to view the tree for verification of the information provided herein. Also, failure to provide adequate or correct contact information will invalidate this notice.

This form may only be used for trees meeting the criteria provided in the BMC Chapter 12.12. It shall not be used for trees located in the public right-of-way, or on any property owned by others who are not listed and signed on to this form.

PETER Bockrath
Owner First Name Last Name

Address of Tree(s) Proposed for Removal 306 Humboldt

If notice is for removal, is the tree a Protected Tree (see definitions on page 3 of this form)? [] Yes [] No
If you answered "Yes" to the above, please STOP and complete an Application for Protected Tree Removal instead.

Table with 6 columns: Photo ID #, Trimming or Removal (T or R), Species (Scientific and Common Name), Invasive (Yes/No). If yes, cite reference., Tree circumference at 2 Ft. above Grade, Description of Tree Location. Handwritten entry: R, MONTEREY PINE, N, 40", FRONT YARD.

Attach a photo of each tree, keyed to a site plan or aerial photo indicating the location of each tree to be trimmed or removed for field verification. Required attachments:

- [X] Site plan or aerial photo showing tree locations(s) and [X] One or more photos of each tree

Owner's Information:

[Redacted] _____
 Owner First Name _____ Last Name _____
 [Redacted] _____
 Mailing Street # _____ Mailing Street _____ Mailing City _____ Mailing State _____ Mailing Zip _____
 Email [Redacted] _____ Phone [Redacted] _____

OWNER ACKNOWLEDGMENT

The information submitted herein is true and correct and I have read and agree to the standard conditions of approval provided on page 4 of this form.

Property Owner's Signature (required) [Redacted] Date Nov 9, 2010

If an agent is submitting on behalf of the owner, provide the following additional information:

 Agent First Name _____ Agent Last Name _____ Business Name _____

 Business Street # _____ Street _____ City _____ State _____ Zip _____
 Email _____
 Business Phone _____ Mobile Phone _____
 Agent Signature (required) _____ Date _____

Submit to City of Brisbane
 Attn: Ken Johnson, Senior Planner
 50 Park Place, Brisbane, CA 94005
 Phone (415) 508-2120 / Fax (415) 467-5547
kjohnson@brisbaneca.org

For staff use only

Date Received 11/9/20 Reviewed by [Signature]

RECEIVED

NOV - 9 1920

Comm. Dev. Dept. Brisbane

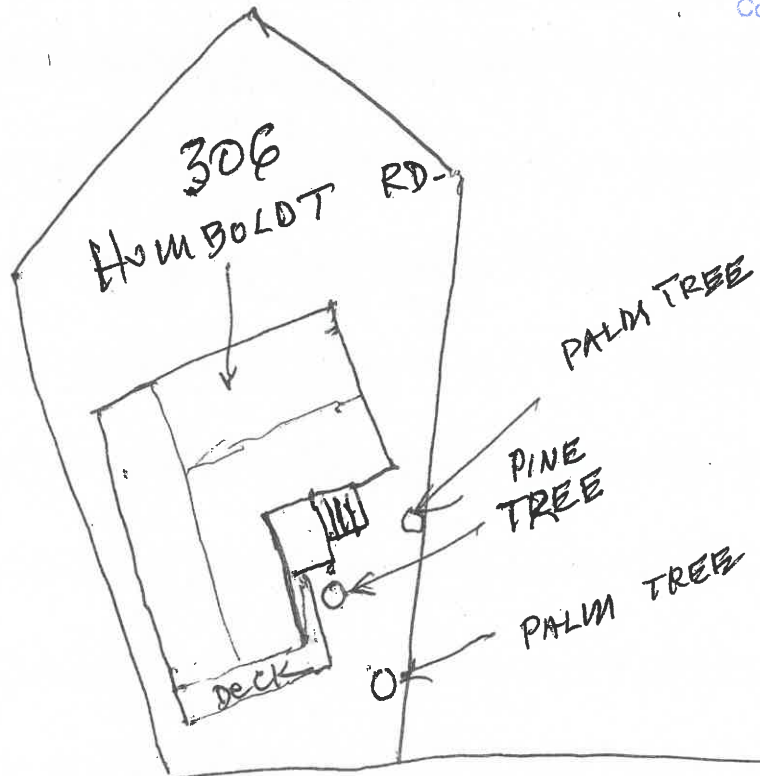



306





